

Residence
215

3 Bedrooms 3 Bathrooms

~2230 Sq. Ft.

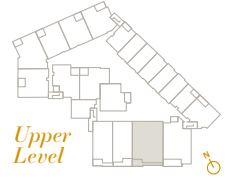

*The floor plan shown is for reference purposes only and may not represent the exact layout of a specific residence. For example, the actual floor plan layout may be a reverse layout or may have slight variations from what is depicted on this plan. Please check with a sales representative to confirm the floor plan of a specific residence.



600 HARTZ AVE. DANVILLE CA 94526 | 925.588.7800 | SALES@600HARTZ.COM | 600HARTZ.COM



© 2023 | Exclusively represented by Coldwell Banker CA DRE License #02101181. This is not an offer to sell but is intended for information only. The developer reserves the right to make modifications in materials, specifications, plans, designs, pricing, scheduling, and delivery of homes without prior notice. All dimensions and square footage are approximate and subject to change and normal construction variances and tolerances. Plans Are Not To Scale.